

CK4W

PRODUCT FEATURES

- Wireless keyboard with fully enclosed Gorilla® glass surface
- Washable and disinfectable; therefore a high level of hygiene and cleanliness
- Keylock function for cleaning the keyboard
- LED prompts to clean the keyboard
- Complete key layout with integrated touchpad
- 2.4 GHz wireless technology
- Volume and sensitivity adjustable individually
- Rearside VESA mounting
- Wide range of customisation options
- EMC according to standard EN 60601-1-2 Edition 4
- USB dongle and charging cable included
- **Please note:** A charging adapter >>IN: 120~240V AC; OUT: 5V 1,0A DC USB-A<< (not included) is required to charge the integrated lithium-ion battery.

SPECIFICATION

GENERAL:	
Number of buttons:	103
Construction:	Desktop keyboard
Housing material:	Plastic
Surface material:	0.8 mm Gorilla® glass
Switching technology:	capacitive
Degree of protection:	IP65 rated
Interface:	USB (USB dongle, 2.4 GHz)
USB compatibility:	compliant with USB 2.0
Charging port:	Socket USB 2.0 Mini-B
Operating temperature:	0 °C to +45 °C
Storage temperature:	-10 °C to +45 °C
System requirements:	Win®, MacOS® and Linux® *

Dimensions:	470 x 167 x 25,4 mm
Dongle dimensions:	48 x 17 x 9 mm
Compliance:	
-- Europe:	CE
-- USA/Canada:	FCC Part 15 Subpart B
-- Global:	REACH,
	RoHS self-declaration
Warranty:	4 years on electrical function
TOUCHPAD:	
Operating principle:	capacitive
Dimensions:	60 x 42 mm

ORDERING INFORMATION

Art No	Product name	Layout
KR24230	TKR-103-TOUCH-RF-KGEH-VESA-WHITE-USB-DE	German
KR24231	TKR-103-TOUCH-RF-KGEH-VESA-WHITE-USB-US/EU	US/EU
KR25207	TKR-103-TOUCH-RF-KGEH-VESA-WHITE-USB-CH	Swiss
KR25205	TKR-103-TOUCH-RF-KGEH-VESA-WHITE-USB-FR	French
KR25206	TKR-103-TOUCH-RF-KGEH-VESA-WHITE-USB-SKAN	Scandinavian
KR25211	TKR-103-TOUCH-RF-KGEH-VESA-WHITE-USB-UK	UK

Other Layouts on request.





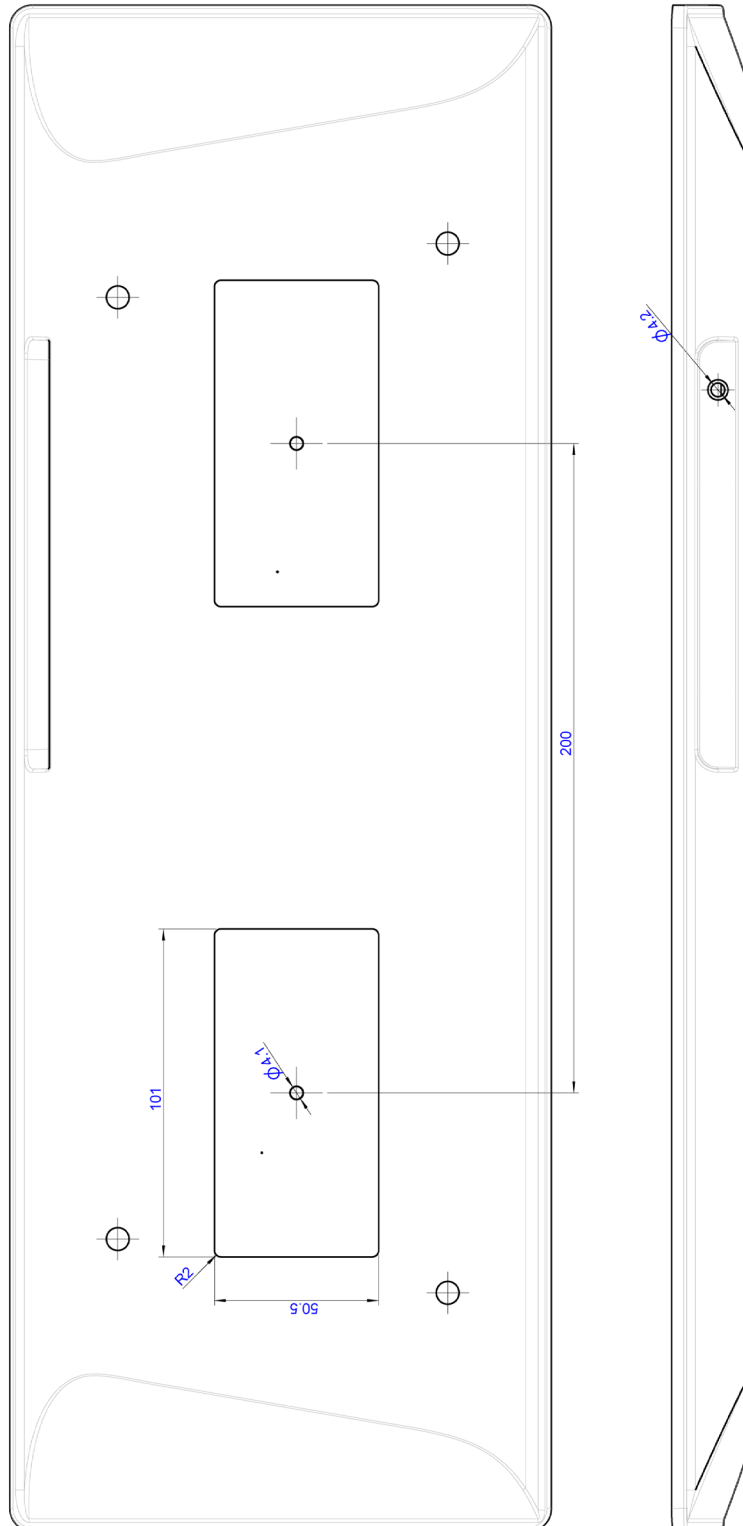
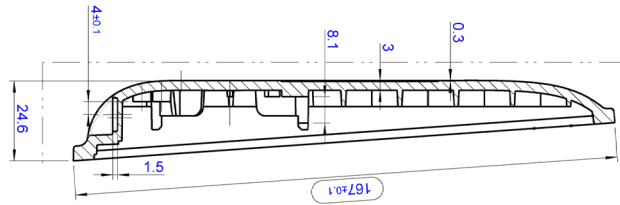

* if the operating system and hardware meet the specifications for USB 2.0 compatibility

TECHNICAL DRAWING (in mm)



ADDITIONAL KEY FUNCTIONS OF THE CK4W KEYBOARD

----- The LED bar indicates the battery charge level, the sensitivity and volume settings and the key lock.

	+		<p>STATUS KEY</p> <p>When the status button is touched, the battery charge status is indicated in eight levels via the LED bar.</p>
	+		<p>The SENSITIVITY can be set as shown (ascending).</p> <p>Level 1 ○ ○ ○ ● ● ○ ○ ○</p> <p>Level 2 ○ ○ ● ● ● ● ○ ○</p> <p>Level 3 ○ ● ● ● ● ● ● ○</p> <p>Level 4 ● ● ● ● ● ● ● ●</p>
	+		<p>The VOLUME can be adjusted as shown (ascending).</p> <p>Level 1 ● ○ ○ ○ ○ ○ ○ ○</p> <p>Level 2 ● ● ○ ○ ○ ○ ○ ○</p> <p>Level 3 ● ● ● ● ○ ○ ○ ○</p> <p>Level 4 ● ● ● ● ● ● ○ ○</p> <p>Level 5 ● ● ● ● ● ● ● ●</p>
			<p>KEYLOCK FUNCTION</p> <p>Press and hold the keylock button for approx. 2 seconds - during this time the LED bar flashes. If it lights up green continuously, the keys are locked. To unlock the keys, press and hold the keylock key for 2 seconds until the LEDs go out. The keys are then functional again.</p>

CLEANING

The glass surface can be cleaned with conventional cleaning agents or disinfectants during the key lock. The chemical resistance of the glass surface may vary depending on the concentration of the solution and the respective environmental conditions. We therefore recommend careful testing of the cleaning agents and disinfectants used for their effect on glass surfaces.

INDIVIDUAL MODIFICATIONS

- Add logo (1 - 4 colours)
- New country layout
- New GUI design
- Cable shortening
- Change of key table (HID standard)